

1/4

1 HARDTOP 1 SET

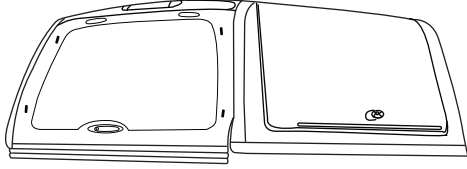

2 INSTALLATION KIT 1 BOX



1

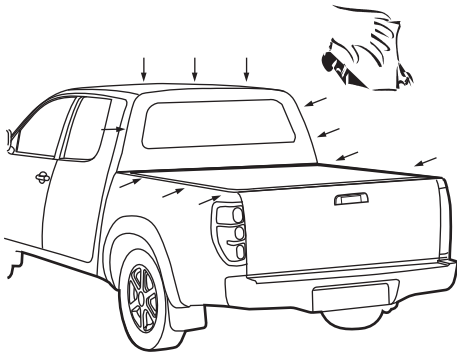

2

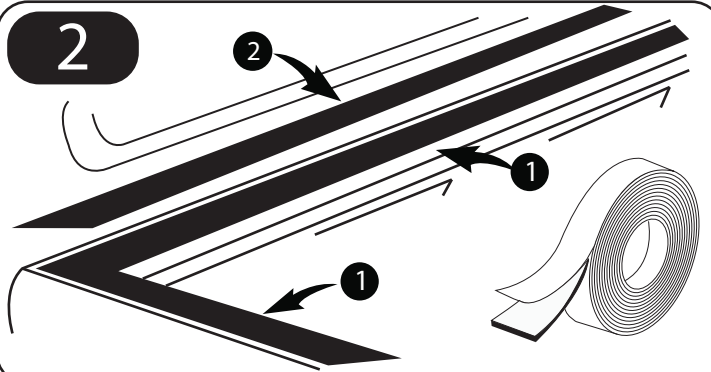

3

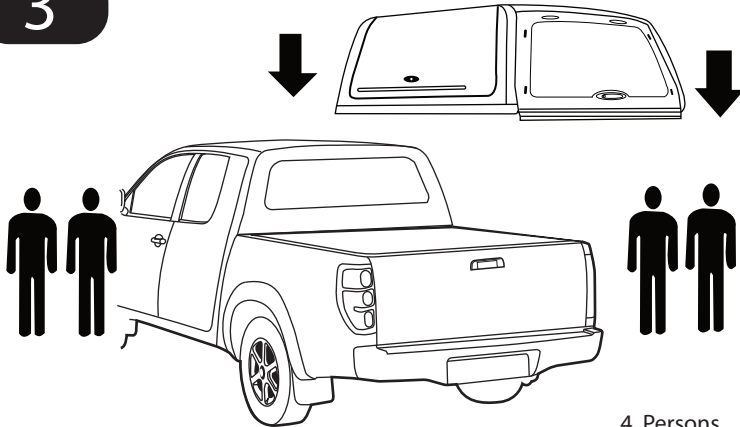

4 Persons

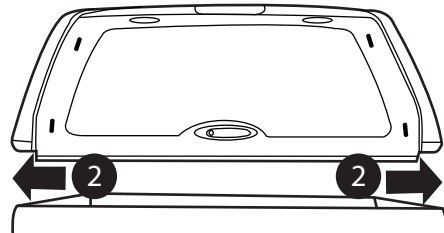
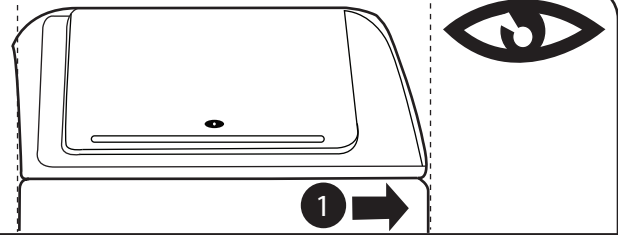

4

FOR 6 POSITIONS

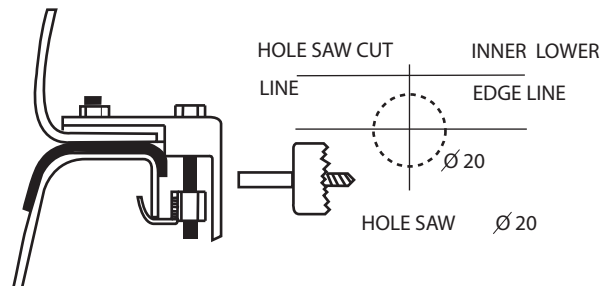
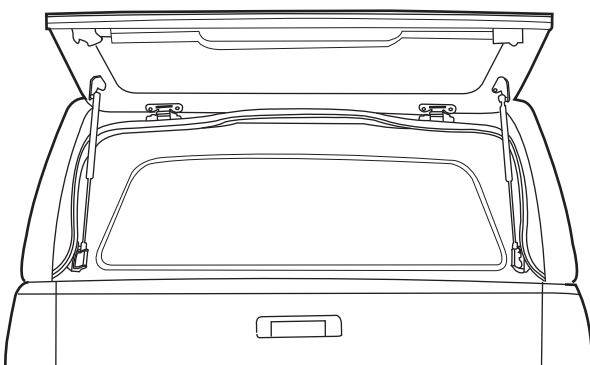

In the case of having bed liner, the bed liner must be drilled with a hole saw  $\varnothing 20$  mm at the same level of truck's inner lower edge.

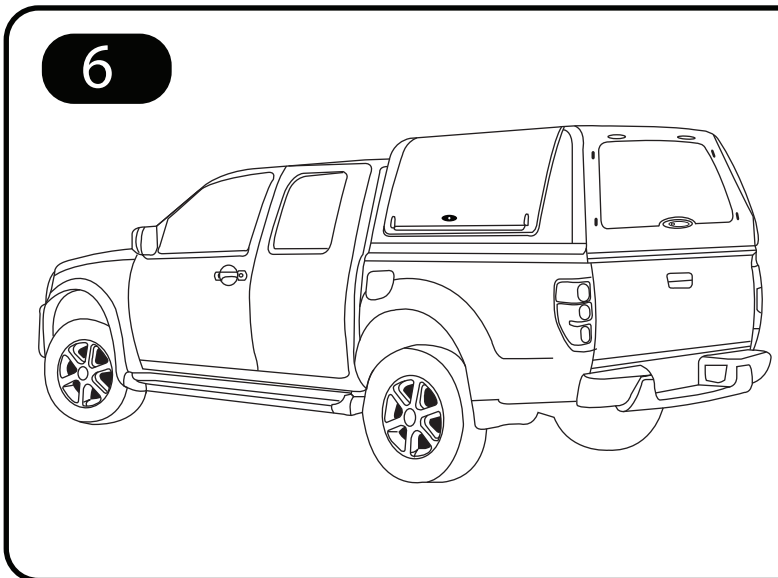
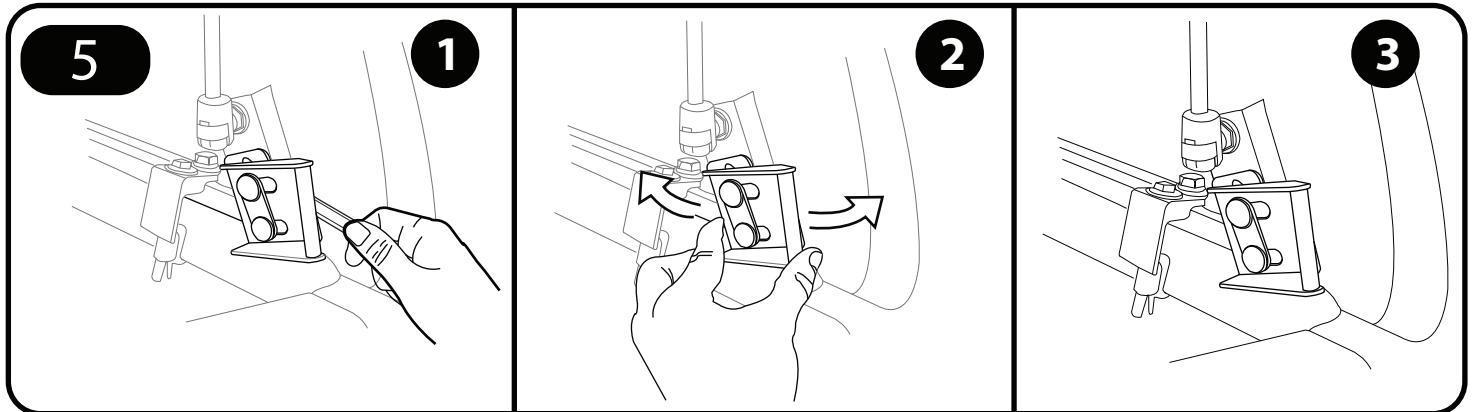

Installation manual for a hardtop

- 1). Clean the edge of truck bed box.
- 2). Install the weather strip on the truck bed box
- 3). Place the hardtop on the edge of truck bed box. and adjust alignment between left and right
- 4). Install quick clamps for 6 positions.
- 5). Adjust a latch R/L for matching with the rotary lock on the rear door
- 6). Final check the appearance.

**- General Notes**

- Carefully read through the fitting instruction before **do the** installation.
- Always install the accessory following the fitting instructions. Failure to do so may cause a damage to the vehicle or the **accessory**
- Ensure all recyclable discarded vehicle accessory components and packaging are recycled following local recycling regulations.
- It is always recommended that this accessory is fitted by a qualified technician
- Safely store and protect any removed vehicle components.
- Ensure all bare metal surfaces are protected using Automotive Bare Metal Primer and touch-up paint.
- Remove all metal swarf and dust from all vehicle surfaces if surface is used for accessory installation.

**- Safety Notes**

- Check that all work practices comply with safety standards.
- Please wear appropriate clothing and use safety equipment.



**- Fitting Time**



15 minutes.

#### - Fitting Components

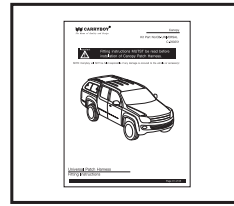
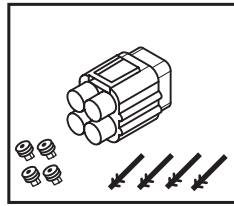
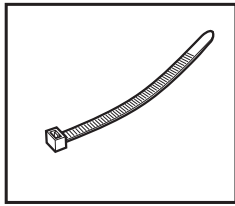
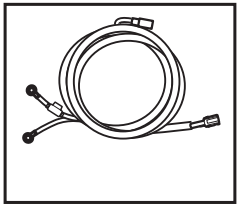

#### - Fitting Tools

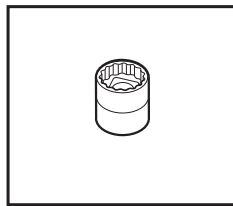
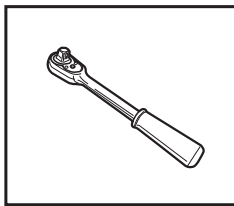
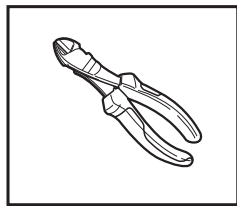

#### - Step 1

- In the engine bay locate and disconnect the negative battery terminal (1)

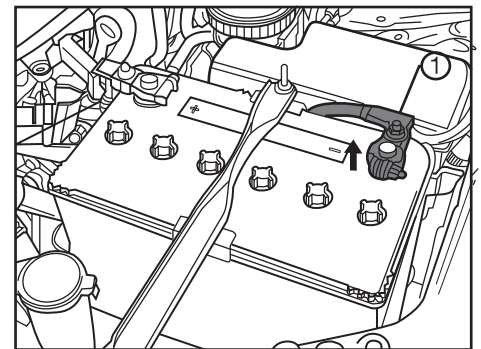

#### - Step 2

- At the rear of the vehicle open the tailgate door (1).

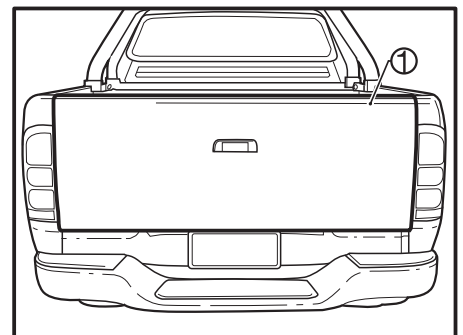

#### - Step 3

NOTE: The Universal Harness runs down the LHS or RHS of the vehicle depending on the engine bay battery location. The following shows steps relating to the LHS of the vehicle. Use the RHS of the vehicle if the engine bay battery is located to the RHS.

- Remove the tail light assembly (1) on the same side of the battery by removing the fasteners (2) holding it in place.
- Disconnect the tail light assembly connectors (3).

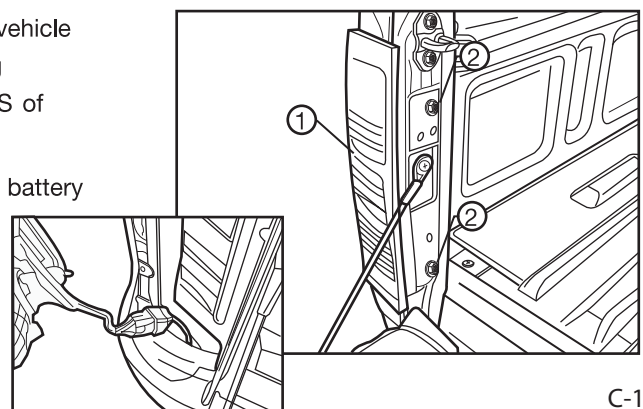

### - Step 4

- Route the Universal Power Harness (1) from the engine battery area (2), down the chassis rail (3) towards the rear of the cabin area (4).

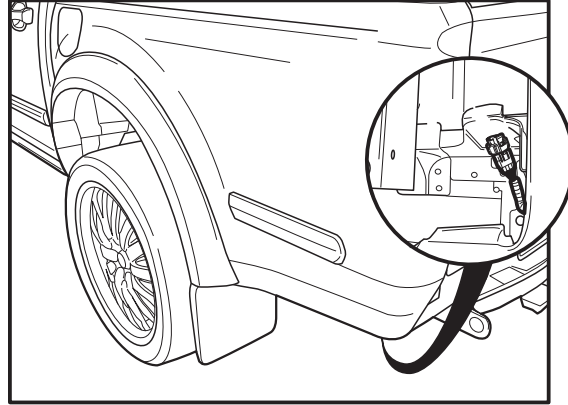
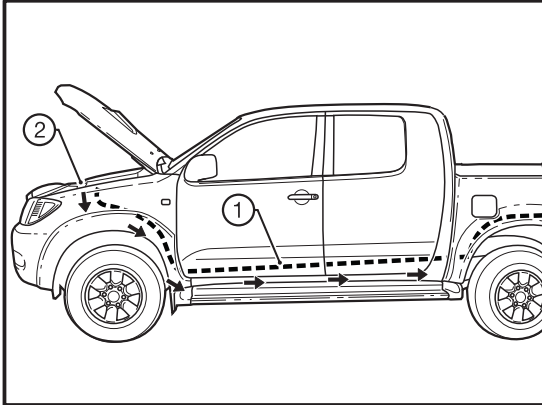

### - Step 5

- Connect Following pic 1-4

#### Wiring from hardtop

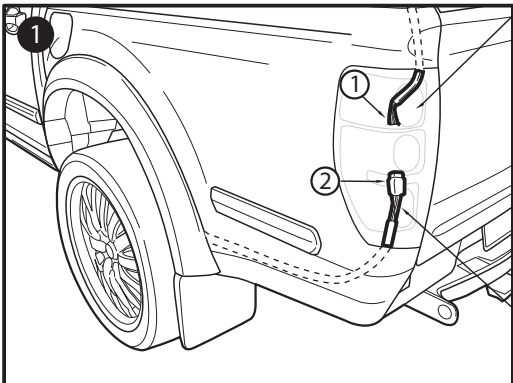

Wiring harness

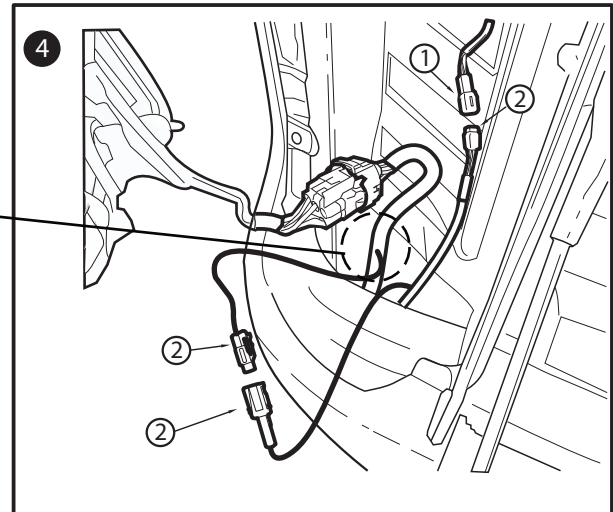
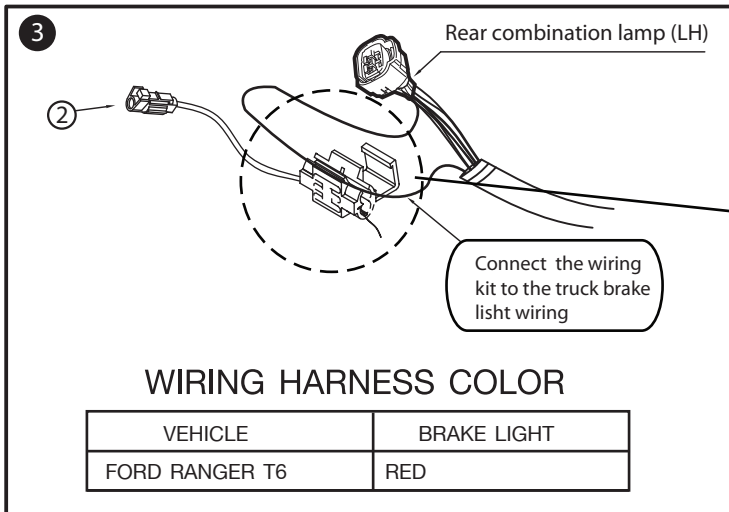
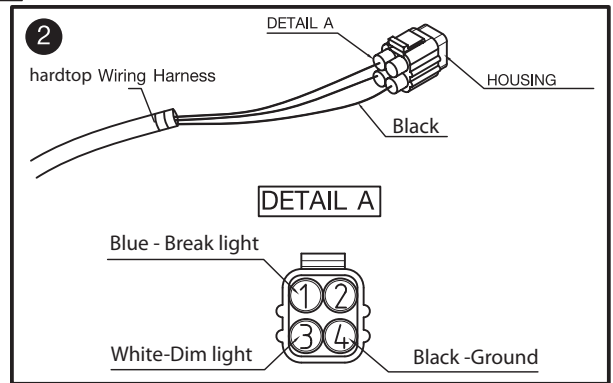

- Re-tighten all bolts and nuts every 5,000 km.